

**RESOLUTION NO. \_\_\_\_\_**

**A RESOLUTION OF THE COMMISSIONERS COURT OF LAMB COUNTY, TEXAS, AUTHORIZING THE COUNTY JUDGE OF LAMB COUNTY, OR HIS DESIGNEE, TO ENTER INTO A MULTIPLE-USE AGREEMENT WITH THE TEXAS DEPARTMENT OF TRANSPORTATION TO PERMIT THE INSTALLATION AND OPERATION OF AUTOMATED LICENSE PLATE RECOGNITION CAMERAS WITHIN US 84 AT COUNTY LINE NORTH BOUND; HALL AVENUE AND E. 28TH STREET NORTH BOUND; US HIGHWAY 385 AND CR 282 SOUTH BOUND; US HIGHWAY 385 AND CR 282 NORTH BOUND; US 84 AND MCCARTY STREET EAST BOUND; HALL AVENUE AND E. 28TH STREET SOUTH BOUND;**

**WHEREAS,** the Commissioners Court of Lamb County, Texas, has requested that the Texas Department of Transportation (TXDOT) permit the installation and operation of automated license plate recognition cameras on US 84 at county line north bound; Hall Avenue and E. 28th Street north bound; US Highway 385 and CR 282 south bound; US Highway 385 and CR 282 north bound; US 84 and McCarty Street east bound; Hall Avenue and E. 28th Street south bound; and

**WHEREAS,** the Commissioners Court of Lamb County, Texas, authorizes the execution of a Multiple Use Agreement with TXDOT for the purposes provided above; and

**WHEREAS,** the Commissioners Court of Lamb County, Texas, finds it to be in the public interest to authorize the County Judge of Lamb County, or his designee, to sign the document referenced above.

**NOW, THEREFORE, BE IT RESOLVED BY THE COMMISSIONERS COURT OF LAMB COUNTY, TEXAS:**

Section 1. **THAT** the Commissioners Court of Lamb County, Texas, authorizes the County Judge of Lamb County, or his designee, to enter into a Multiple Use Agreement with TXDOT, which will permit the installation of automated license plate recognition cameras on US 84 at county line north bound; Hall Avenue and E. 28th Street north bound; US Highway 385 and CR 282 south bound; US Highway 385 and CR 282

north bound; US 84 and McCarty Street east bound; Hall Avenue and E. 28th Street  
south bound;

**AND IT IS SO RESOLVED.**

**PASSED AND APPROVED** this 10 day of February, 2025.

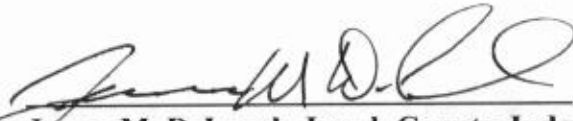

**James M. DeLoach, Lamb County Judge**

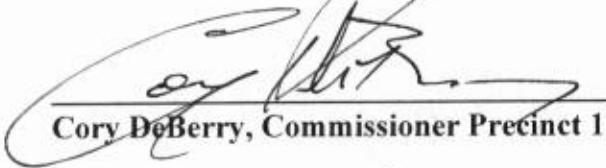

**Cory DeBerry, Commissioner Precinct 1**



**Kent Lewis, Commissioner Precinct 2**



**Danny Short, Commissioner Precinct 3**



**Lee Logan, Commissioner Precinct 4**

**ATTEST:**



**Rene Trevino,  
Lamb County Clerk**



**APPROVED AS TO FORM:**



**Rickie R. Redman,  
County Attorney**

FLOCK SAFETY EQUIPMENT INSTALLATION

CASE NUMBER: 00876058  
PERMITTING JURISDICTION:  
Texas (DOT) Lubbock (5), Right-of-Way

Texas (DOT) Lubbock (5), Right-of-Way  
ON BEHALF OF  
TX - Lubbock County SO

CONTACT LIST

PERMITTING  
cody.boudreaux@flocksafety.com  
PROJECT MANAGER  
joseph.belidman@flocksafety.com  
SEE APPROVED PERMIT FOR LISTED INSPECTOR\*

DRAWING INDEX

T.01	COVER SHEET & LOCATION MAPS
GN.01	GENERAL NOTES
A.01 - A.05	PLAN DRAWINGS
SPEC.01 - SPEC.03	EQUIPMENT & FOUNDATION DETAILS



Know what's below.  
Call before you dig.

THIS DOCUMENT HAS BEEN DRAWN BASED OFF THE MOST RECENT AVAILABLE DATA & AERIAL IMAGERY. THE INSTALLER MUST BE RESPONSIBLE FOR VERIFYING ALL DATA PRIOR AND DURING SURVEYING AND MUST BE RESPONSIBLE FOR VERIFYING ALL DATA PRIOR AND DURING SURVEYING AND MUST BE RESPONSIBLE FOR VERIFYING ALL DATA PRIOR AND DURING SURVEYING. CALL 877-PICKUP (11735286) OF TRANSPORTATION DEPARTMENT, COLUMBIA, SOUTH CAROLINA 29204-0001 FOR MORE INFORMATION.

TX - Lubbock County SO

TX - Lubbock County SO  
00876058

Flock Safety  
1170 HOWELL MILL ROAD SUITE 210  
ATLANTA, GA 30318

REV	DATE	BY	DESCRIPTION
-	-	-	-
-	-	-	-
-	-	-	-
-	-	-	-
0	12/30/2024	FLK	PRELIM

I HEREBY CERTIFY THIS DOCUMENT WAS PREPARED BY MYSELF OR UNDER MY CLOSE PERSONAL SUPERVISION AND TO THE BEST OF MY KNOWLEDGE AND BELIEF IT COMPLIES WITH ALL CITY, STATE AND FEDERAL REQUIREMENTS AND STANDARDS FOR THE DESIGN AND CONSTRUCTION OF THE PROJECT.

Blank area for drawing or notes.

FLOCK SAFETY EQUIPMENT INSTALLATION  
CASE NUMBER: 00876058  
PERMITTING JURISDICTION: Texas (DOT) Lubbock (5), Right-of-Way

COVER SHEET & LOCATION MAPS	REV
SHEET: T.01	0

# GENERAL & CONSTRUCTION NOTES

1. ALL CONSTRUCTION SHALL BE IN ACCORDANCE WITH STATE AND LOCAL AGENCY SPECIFICATIONS UNLESS SPECIFICALLY STATED OR SHOWN OTHERWISE HEREIN.
2. ALL WORK SHALL CONFORM TO ALL APPLICABLE ELECTRICAL CODES EXCEPT WHEN STATE DEPARTMENT OF TRANSPORTATION AND LOCAL AGENCY STANDARDS SUPERSEDE.
3. CONTRACTOR SHALL ENSURE ALL PROPOSED EQUIPMENT INSTALLED IS IN ACCORDANCE WITH NECO REQUIREMENTS AND CLEARANCES.
4. ALL CONSTRUCTION AND/OR MAINTENANCE ON THE TEXAS DEPARTMENT OF TRANSPORTATION RIGHT OF WAY SHALL CONFORM TO THE TEXAS DEPARTMENT OF TRANSPORTATION STANDARDS FOR TRANSPORTATION ROADWAY AND TRAFFIC DESIGN STANDARDS SPECIFICATIONS FOR ROAD AND BRIDGE CONSTRUCTION, STANDARD DRAWING AND DRAWING MANUAL, OF WORK AND RESTRICTIONS THAT MAY BE REQUIRED TO POSITIVELY SUPPORT LIFE, SAFETY AND ENVIRONMENTAL WILL BEING OF ALL USERS OF THE TRANSPORTATION SYSTEM.
5. THE PERMITTING AGENCY RESERVES THE RIGHT TO MAKE ADJUSTMENTS TO ANY PERMITTED LENGTH OF INSTALLATION, SCOPE OF WORK AND RESTRICTIONS THAT MAY BE REQUIRED TO POSITIVELY SUPPORT LIFE, SAFETY AND ENVIRONMENTAL WILL BEING OF ALL USERS OF THE TRANSPORTATION SYSTEM.
6. SHOULD A CONFLICT ARISE BETWEEN THE DETAILS SHOWN IN THE PLANS AND THE DEPARTMENT OF TRANSPORTATION STANDARDS, THE ENGINEER/PERMITTEE SHALL IMMEDIATELY CONFER WITH THE DEPARTMENT'S ENGINEER IN ORDER TO RESOLVE THE DISCREPANCY. IN NO CASE WILL ANYTHING LESS THAN THE DEPARTMENT'S MINIMUM STANDARDS BE ALLOWED.
7. FLOOD SAFETY SHALL BE RESPONSIBLE FOR LOCATING ALL UNDERGROUND UTILITIES 48 HOURS PRIOR TO CONSTRUCTION.
8. INSTALLATION OF FLOOD SAFETY PROVIDED POLAR A MINIMUM OF 2 SEPARATION SHALL BE MAINTAINED FROM ALL EXISTING UTILITIES AND STORM DRAIN STRUCTURES.
9. THE PERMITTED WORK SCHEDULE IS DEFINED AS MONDAY THROUGH FRIDAY 7:00AM TO 5:00PM UNLESS OTHERWISE NOTED WITHIN THE PERMIT. ANY WORK DEEMED OUTSIDE OF THIS PERIOD MUST BE REQUESTED IN ADVANCE AND APPROVED BEFORE WORKING.
10. FLOOD SAFETY SHALL BE RESPONSIBLE TO APPLY AND DESIGN AN APPROVED TRAFFIC CONTROL PLAN IN ACCORDANCE WITH MUTCD AND LOCAL AGENCY STANDARDS FOR TRAFFIC CONTROL.
11. WORKMANHOOD TEMPORARY ACCESS CLOSURES ARE TO BE DONE BETWEEN THE HOURS OF 8:00AM AND 5:00PM MONDAY THROUGH FRIDAY UNLESS OTHERWISE STATED BY THE DEPARTMENT OF TRANSPORTATION.
12. CONTRACTOR SHALL MAINTAIN SAFE ACCESS FOR ALL PEDESTRIAN TRAFFIC REGULATIONS ON ALL EXCAVATIONS OPENED IN THE TRAFFIC ZONE CONTROL AREA.
13. NO PEDESTRIAN PATHWAY IS TO BE REMOVED, BLOCKED, OR OTHERWISE INTERRUPTED DURING A SUPERVISOR DESIGNATED TEMPORARY PEDESTRIAN PATHWAY WITH ALL APPROPRIATE PEDESTRIAN MAINTENANCE OF TRAFFIC SIGNS IN PLACE PRIOR TO REMOVAL BEING AFFECTED.
14. ALL TEMPORARY PEDESTRIAN PATHWAYS MUST BE FIRM AND LEVELING.
15. CONTRACTOR SHALL MAINTAIN ACCESS TO ALL ADJACENT PROPERTY IN THE VICINITY OF THE CONSTRUCTION.
16. NO WORK SHALL BE PERFORMED DURING THE WEEKS OF ANY STATE OR FEDERAL HOLIDAYS UNLESS OTHERWISE APPROVED BY THE TEXAS DEPARTMENT OF TRANSPORTATION.
17. ALL WORK DONE ARE TO BE SET UP AND MAINTAINED BY SOMEONE WHO HAS THE TEXAS DEPARTMENT OF TRANSPORTATION INTERMEDIATE TRAFFIC CONTROL, LEVEL, TYPING OR EQUIVALENT.
18. THE PERMITTING AGENCY RESERVES THE RIGHT TO MAKE ALTERATIONS TO THE PERMIT, ATTACHED SKETCH OR CHARACTER OF WORK AS MAY BE CONSIDERED NECESSARY OR DESIRABLE DURING THE PROGRESS OF THE WORK FOR SAFETY OR COMPLETION OF THE PROPOSED CONSTRUCTION.
19. THE PERMITTEE SHALL NOTIFY THE PERMITTING AGENCY OF DATE OF COMPLETION, REQUEST A FINAL INSPECTION AND A NOTICE OF FINAL ACCEPTANCE.
20. IF THE PROPOSED CANNOT BE INSTALLED PER THE APPROVED PERMITTED PLAN AND BY GENERAL SPECIFICATIONS, A REVISED PLAN MUST BE SUBMITTED TO THE DEPARTMENT FOR REVIEW AND APPROVAL, PRIOR TO THE INSTALLATION OF PRODUCTS OR MATERIALS AT THE GIVEN LOCATION WHERE CONFLICTS OCCUR.
21. CONTRACTOR SHALL RESTORE RIGHT-OF-WAY TO EQUAL OR BETTER CONDITION UPON COMPLETION OF WORK AND TO THE SATISFACTION OF THE STATE DEPARTMENT OF TRANSPORTATION AND LOCAL AGENCY AT NO ADDITIONAL COMPENSATION.
22. ANY SIDEWALK AND/OR DRIVEWAY WILL BE REPLACED BY SECTION WITHIN 12 HOURS TO THE STATE DEPARTMENT OF TRANSPORTATION STANDARDS.
23. IT IS THE RESPONSIBILITY OF THE PERMITTEE TO REMAIN ANY DAMAGE TO GENERAL FACILITIES AND/OR PRIVATE PROPERTY CAUSED BY CONSTRUCTION OF THE PROJECT.
24. ALL EXISTING UTILITIES, CROSSING GUTTERS AND STORMWATER COLLECTORS WILL BE KEPT FREE OF MUD AND OTHER DEBRIS AT ALL TIMES DURING CONSTRUCTION.
25. NO STOPPING, STORING OR SEMI-PERMANENT USE OF THE RIGHT OF WAY IS AUTHORIZED UNLESS SPECIFICALLY IDENTIFIED WITHIN THE PERMIT.
26. THE CONTRACTOR SHALL HAVE AN AUTHORIZED PERSON AVAILABLE AT OR NEAR THE WORK SITE TO ADDRESS EMERGENCY ISSUES ASSOCIATED WITH THE PROJECT.
27. AOA COMPLIANCE NOTICE
28. ALL SIDEWALK CONSTRUCTION SHALL BE IN ACCORDANCE WITH AOA TITLE II AND ALL STATE DEPARTMENT OF TRANSPORTATION AND LOCAL STANDARDS. USE STATE DEPARTMENT OF TRANSPORTATION CURRENT EDITION STANDARDS FOR PEDESTRIAN CONTROL PLANS FOR CLOSURE OF SIDEWALK.
29. MINIMUM SIDEWALK CLEAR PEDESTRIAN ACCESS ROUTE (PAV) IS 4' WIDE.
30. NO OBSTRUCTION IS PERMITTED ALONG THE WIDTH OF THE SIDEWALK UP TO 7'-0" IN HEIGHT.

# DRAWINGS

1. THE WORK SHALL BE PERFORMED IN STRICT ACCORDANCE WITH THE FOLLOWING ATTACHED DRAWINGS THAT ARE HEREBY MADE A PART OF THE STATEMENT OF WORK BY THIS REFERENCE.
2. THE WORK SHALL BE PERFORMED IN STRICT ACCORDANCE WITH THE SPECIFICATIONS CONTAINED IN THE TEXAS DEPARTMENT OF TRANSPORTATION STANDARD DRAWING AND DRAWING MANUAL, OF WORK AND RESTRICTIONS THAT MAY BE REQUIRED TO POSITIVELY SUPPORT LIFE, SAFETY AND ENVIRONMENTAL WILL BEING OF ALL USERS OF THE TRANSPORTATION SYSTEM.
3. THE PERMITTING AGENCY RESERVES THE RIGHT TO MAKE ADJUSTMENTS TO ANY PERMITTED LENGTH OF INSTALLATION, SCOPE OF WORK AND RESTRICTIONS THAT MAY BE REQUIRED TO POSITIVELY SUPPORT LIFE, SAFETY AND ENVIRONMENTAL WILL BEING OF ALL USERS OF THE TRANSPORTATION SYSTEM.
4. SHOULD A CONFLICT ARISE BETWEEN THE DETAILS SHOWN IN THE PLANS AND THE DEPARTMENT OF TRANSPORTATION STANDARDS, THE ENGINEER/PERMITTEE SHALL IMMEDIATELY CONFER WITH THE DEPARTMENT'S ENGINEER IN ORDER TO RESOLVE THE DISCREPANCY. IN NO CASE WILL ANYTHING LESS THAN THE DEPARTMENT'S MINIMUM STANDARDS BE ALLOWED.
5. FLOOD SAFETY SHALL BE RESPONSIBLE FOR LOCATING ALL UNDERGROUND UTILITIES 48 HOURS PRIOR TO CONSTRUCTION.
6. INSTALLATION OF FLOOD SAFETY PROVIDED POLAR A MINIMUM OF 2 SEPARATION SHALL BE MAINTAINED FROM ALL EXISTING UTILITIES AND STORM DRAIN STRUCTURES.
7. THE PERMITTED WORK SCHEDULE IS DEFINED AS MONDAY THROUGH FRIDAY 7:00AM TO 5:00PM UNLESS OTHERWISE NOTED WITHIN THE PERMIT. ANY WORK DEEMED OUTSIDE OF THIS PERIOD MUST BE REQUESTED IN ADVANCE AND APPROVED BEFORE WORKING.
8. FLOOD SAFETY SHALL BE RESPONSIBLE TO APPLY AND DESIGN AN APPROVED TRAFFIC CONTROL PLAN IN ACCORDANCE WITH MUTCD AND LOCAL AGENCY STANDARDS FOR TRAFFIC CONTROL.
9. WORKMANHOOD TEMPORARY ACCESS CLOSURES ARE TO BE DONE BETWEEN THE HOURS OF 8:00AM AND 5:00PM MONDAY THROUGH FRIDAY UNLESS OTHERWISE STATED BY THE DEPARTMENT OF TRANSPORTATION.
10. CONTRACTOR SHALL MAINTAIN SAFE ACCESS FOR ALL PEDESTRIAN TRAFFIC REGULATIONS ON ALL EXCAVATIONS OPENED IN THE TRAFFIC ZONE CONTROL AREA.
11. NO PEDESTRIAN PATHWAY IS TO BE REMOVED, BLOCKED, OR OTHERWISE INTERRUPTED DURING A SUPERVISOR DESIGNATED TEMPORARY PEDESTRIAN PATHWAY WITH ALL APPROPRIATE PEDESTRIAN MAINTENANCE OF TRAFFIC SIGNS IN PLACE PRIOR TO REMOVAL BEING AFFECTED.
12. ALL TEMPORARY PEDESTRIAN PATHWAYS MUST BE FIRM AND LEVELING.
13. CONTRACTOR SHALL MAINTAIN ACCESS TO ALL ADJACENT PROPERTY IN THE VICINITY OF THE CONSTRUCTION.
14. NO WORK SHALL BE PERFORMED DURING THE WEEKS OF ANY STATE OR FEDERAL HOLIDAYS UNLESS OTHERWISE APPROVED BY THE TEXAS DEPARTMENT OF TRANSPORTATION.
15. ALL WORK DONE ARE TO BE SET UP AND MAINTAINED BY SOMEONE WHO HAS THE TEXAS DEPARTMENT OF TRANSPORTATION INTERMEDIATE TRAFFIC CONTROL, LEVEL, TYPING OR EQUIVALENT.
16. THE PERMITTING AGENCY RESERVES THE RIGHT TO MAKE ALTERATIONS TO THE PERMIT, ATTACHED SKETCH OR CHARACTER OF WORK AS MAY BE CONSIDERED NECESSARY OR DESIRABLE DURING THE PROGRESS OF THE WORK FOR SAFETY OR COMPLETION OF THE PROPOSED CONSTRUCTION.
17. THE PERMITTEE SHALL NOTIFY THE PERMITTING AGENCY OF DATE OF COMPLETION, REQUEST A FINAL INSPECTION AND A NOTICE OF FINAL ACCEPTANCE.
18. IF THE PROPOSED CANNOT BE INSTALLED PER THE APPROVED PERMITTED PLAN AND BY GENERAL SPECIFICATIONS, A REVISED PLAN MUST BE SUBMITTED TO THE DEPARTMENT FOR REVIEW AND APPROVAL, PRIOR TO THE INSTALLATION OF PRODUCTS OR MATERIALS AT THE GIVEN LOCATION WHERE CONFLICTS OCCUR.
19. CONTRACTOR SHALL RESTORE RIGHT-OF-WAY TO EQUAL OR BETTER CONDITION UPON COMPLETION OF WORK AND TO THE SATISFACTION OF THE STATE DEPARTMENT OF TRANSPORTATION AND LOCAL AGENCY AT NO ADDITIONAL COMPENSATION.
20. ANY SIDEWALK AND/OR DRIVEWAY WILL BE REPLACED BY SECTION WITHIN 12 HOURS TO THE STATE DEPARTMENT OF TRANSPORTATION STANDARDS.
21. IT IS THE RESPONSIBILITY OF THE PERMITTEE TO REMAIN ANY DAMAGE TO GENERAL FACILITIES AND/OR PRIVATE PROPERTY CAUSED BY CONSTRUCTION OF THE PROJECT.
22. ALL EXISTING UTILITIES, CROSSING GUTTERS AND STORMWATER COLLECTORS WILL BE KEPT FREE OF MUD AND OTHER DEBRIS AT ALL TIMES DURING CONSTRUCTION.
23. NO STOPPING, STORING OR SEMI-PERMANENT USE OF THE RIGHT OF WAY IS AUTHORIZED UNLESS SPECIFICALLY IDENTIFIED WITHIN THE PERMIT.
24. THE CONTRACTOR SHALL HAVE AN AUTHORIZED PERSON AVAILABLE AT OR NEAR THE WORK SITE TO ADDRESS EMERGENCY ISSUES ASSOCIATED WITH THE PROJECT.
25. AOA COMPLIANCE NOTICE
26. ALL SIDEWALK CONSTRUCTION SHALL BE IN ACCORDANCE WITH AOA TITLE II AND ALL STATE DEPARTMENT OF TRANSPORTATION AND LOCAL STANDARDS. USE STATE DEPARTMENT OF TRANSPORTATION CURRENT EDITION STANDARDS FOR PEDESTRIAN CONTROL PLANS FOR CLOSURE OF SIDEWALK.
27. MINIMUM SIDEWALK CLEAR PEDESTRIAN ACCESS ROUTE (PAV) IS 4' WIDE.
28. NO OBSTRUCTION IS PERMITTED ALONG THE WIDTH OF THE SIDEWALK UP TO 7'-0" IN HEIGHT.

THIS DOCUMENT HAS BEEN DOWN LOADED OFF THE MOST RECENT AVAILABLE COPY & IS NOT A COPY OF THE ORIGINAL DOCUMENT. THE ORIGINAL DOCUMENT IS AVAILABLE FOR PURCHASE FROM THE TEXAS DEPARTMENT OF TRANSPORTATION. THE ORIGINAL DOCUMENT IS AVAILABLE FOR PURCHASE FROM THE TEXAS DEPARTMENT OF TRANSPORTATION. THE ORIGINAL DOCUMENT IS AVAILABLE FOR PURCHASE FROM THE TEXAS DEPARTMENT OF TRANSPORTATION.

<p>COVER SHEET &amp; LOCATION MAPS</p> <p>SHEET: <b>GN-01</b> REV: <b>0</b></p>			
<p>FLOOD SAFETY EQUIPMENT INSTALLATION</p> <p>CASE NUMBER: 0087058</p> <p>PERMITTING JURISDICTION: TxDOT Lubbock</p> <p>(S) Right-of-Way</p>			
<p>1170 HOWELL WILL ROAD SUITE 210</p> <p>ATLANTA, GA 30318</p> <p>Flood Safety</p> <p>TX - Lubbock County SO</p> <p>0087058</p>			
REV	DATE	BY	DESCRIPTION
-	-	-	-
-	-	-	-
-	-	-	-
0	12/30/2024	FLK	PRELIM

DESIGNED BY: [REDACTED] DRAWN BY: [REDACTED] CHECKED BY: [REDACTED] APPROVED BY: [REDACTED]

THIS DOCUMENT HAS BEEN DOWN LOADED OFF THE MOST RECENT AVAILABLE COPY & IS NOT A COPY OF THE ORIGINAL DOCUMENT. THE ORIGINAL DOCUMENT IS AVAILABLE FOR PURCHASE FROM THE TEXAS DEPARTMENT OF TRANSPORTATION. THE ORIGINAL DOCUMENT IS AVAILABLE FOR PURCHASE FROM THE TEXAS DEPARTMENT OF TRANSPORTATION. THE ORIGINAL DOCUMENT IS AVAILABLE FOR PURCHASE FROM THE TEXAS DEPARTMENT OF TRANSPORTATION.

# FLOCK LOCATION DETAILS

LOCATION NAME: FM307 Hall Ave @ E 28th St NB - Lamb County  
 GEOGRAPHIC COORDINATES:  
 33.800071894162104 -102.32725283980602

STREET NAME/RS #	SPEED LIMIT	TRAFFIC VOLUME	EOP DISTANCE
28th Hall Ave	55	2244	10 #
Corresponding Spec Sheet		SPEC 01-03	



11770 HOWELL WILL ROAD SUITE 210  
 ATLANTA, GA 30318

TX - Lubbock County SO  
 00876058

Flock Safety  
 11770 HOWELL WILL ROAD SUITE 210  
 ATLANTA, GA 30318

REV	DATE	BY	DESCRIPTION
0	12/30/2024	FLK	PRELIM

I HEREBY CERTIFY THIS DOCUMENT WAS PREPARED BY ARTIST OR ENGINEER UNDER THE LAWS OF THE STATE OF TEXAS

THIS DOCUMENT IS NOT VALID UNLESS SIGNED BY THE ENGINEER

FLOCK SAFETY EQUIPMENT INSTALLATION  
 CASE NUMBER: 00876058  
 PERMITTING JURISDICTION: Texas (DOT) Lubbock  
 (S), Right-of-Way

COVER SHEET & LOCATION MAPS  
 SHEET: A.01 REV: 0



FLOCK LOCATION DETAILS

LOCATION NAME: PH008 US 84 @ County Line NB - Lamb County  
 GEOGRAPHIC COORDINATES:  
 33.06280236202288 -102.20139354512214

STREET NAME/SH	SPEED LIMIT	TRAFFIC VOLUME	EOP DISTANCE
US Highway 84	0		0 ft

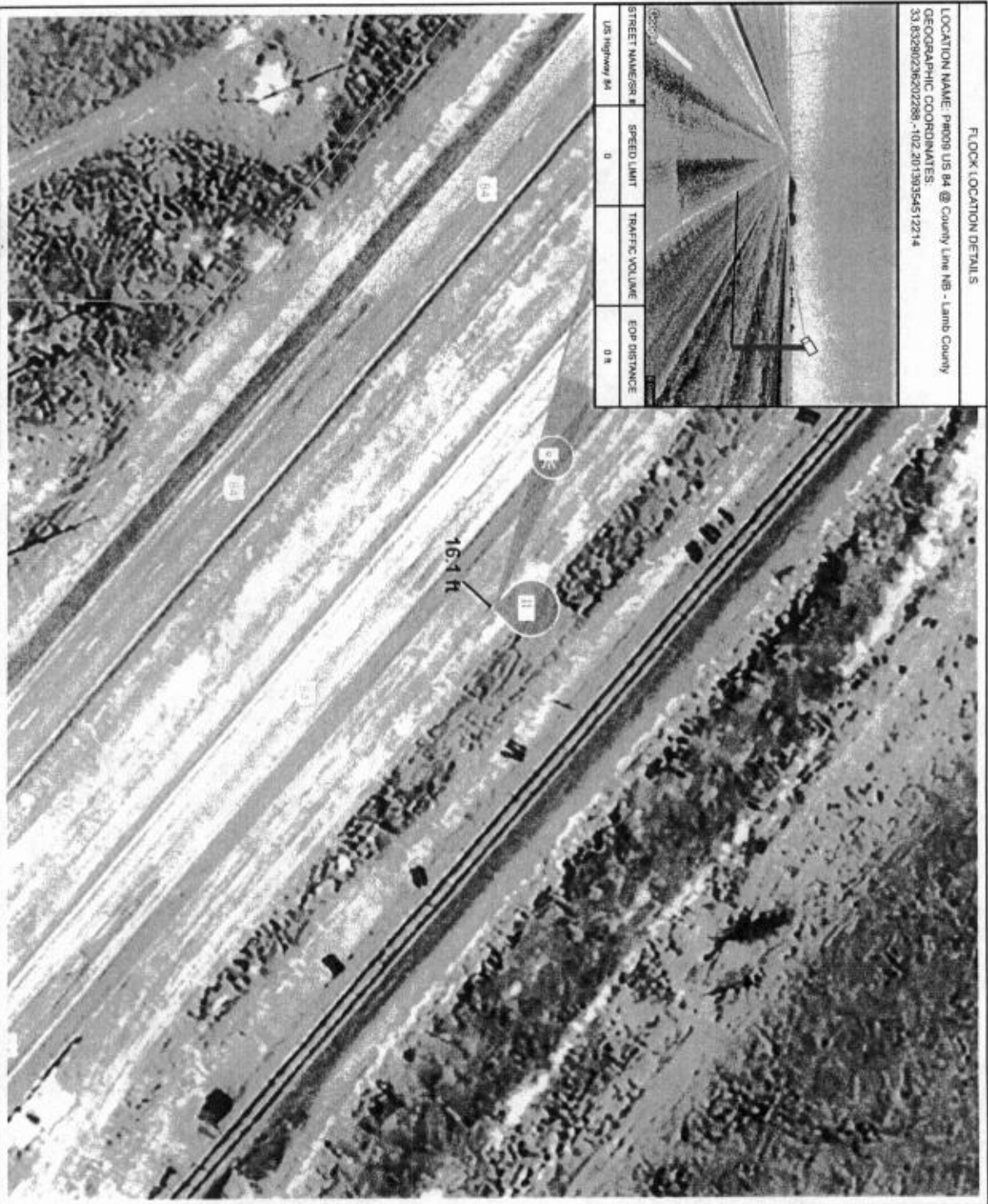

THIS DOCUMENT IS THE PROPERTY OF THE CLIENT. IT IS TO BE USED FOR THE PROJECT ONLY AND NOT TO BE REPRODUCED OR TRANSMITTED IN ANY FORM OR BY ANY MEANS, ELECTRONIC OR MECHANICAL, INCLUDING PHOTOCOPYING, RECORDING, OR BY ANY INFORMATION STORAGE AND RETRIEVAL SYSTEM. THE CLIENT IS RESPONSIBLE FOR OBTAINING ALL NECESSARY PERMITS AND APPROVALS FROM THE APPROPRIATE AGENCIES. THE CLIENT IS RESPONSIBLE FOR OBTAINING ALL NECESSARY PERMITS AND APPROVALS FROM THE APPROPRIATE AGENCIES. THE CLIENT IS RESPONSIBLE FOR OBTAINING ALL NECESSARY PERMITS AND APPROVALS FROM THE APPROPRIATE AGENCIES.

TX - Lubbock County SO  
 00876061

Flock Safety  
 1170 HOWELL MILL ROAD SUITE 210  
 ATLANTA, GA 30318

REV	DATE	BY	DESCRIPTION
-	-	-	-
-	-	-	-
-	-	-	-
0	12/20/2024	FLK	PRELIM

PLEASE VERIFY THIS DOCUMENT WAS PREPARED BY ANSLEY OR UNDER THE DIRECT SUPERVISION AND THAT JAM & TAYLOR ENGINEERS HAS REVIEWED UNDER THE SEAL OF THE STATE OF TEXAS

FLOCK SAFETY EQUIPMENT INSTALLATION  
 CASE NUMBER: 00876061  
 PERMITTING JURISDICTION: Texas (DOT) Lubbock  
 (5) Right-of-Way

COVER SHEET & LOCATION MAPS  
 SHEET A.07 REV 0

# FLOCK LOCATION DETAILS

LOCATION NAME: FM308 US Highway 385 @ County Road 282 SB - Lamb County  
 GEOGRAPHIC COORDINATES:  
 33.94073470953995, -102.32896870711646

STREET NAME/IN #	SPEED LIMIT	TRAFFIC VOLUME	EQP DISTANCE
2820 US Highway 385	65	2244	11.3 ft
Corresponding Spec Sheet			
SPEC 01403			



TX - Lubbock County SO

00876058

Flock Safety  
 1170 HOWELL MILL ROAD SUITE 210  
 ATLANTA, GA 30318

REV	DATE	BY	DESCRIPTION
-	-	-	-
-	-	-	-
-	-	-	-
-	-	-	-
0	12/30/2024	FLK	PRELIM

I HEREBY CERTIFY THIS DOCUMENT WAS PREPARED BY AN INDIVIDUAL WHOSE NAME AND FIRM ARE LISTED ON THE PERMITTING JURISDICTION'S LIST OF QUALIFIED PROFESSIONALS UNDER THE LAWS OF THE STATE OF TEXAS

COVER SHEET & LOCATION MAPS

SHEET: A.02 REV: 0

# FLOCK LOCATION DETAILS

LOCATION NAME: F0038 US Highway 385 @ County Road 282 NB - Lamb County  
 GEOGRAPHIC COORDINATES:  
 33.94016678 108.8777 -102.32689226346076

STREET NAME/SR #	SPEED LIMIT	TRAFFIC VOLUME	EOP DISTANCE
2830 US Highway 385	85	2284	12.8 ft
Corresponding Spec Sheet SPEC 07-403			

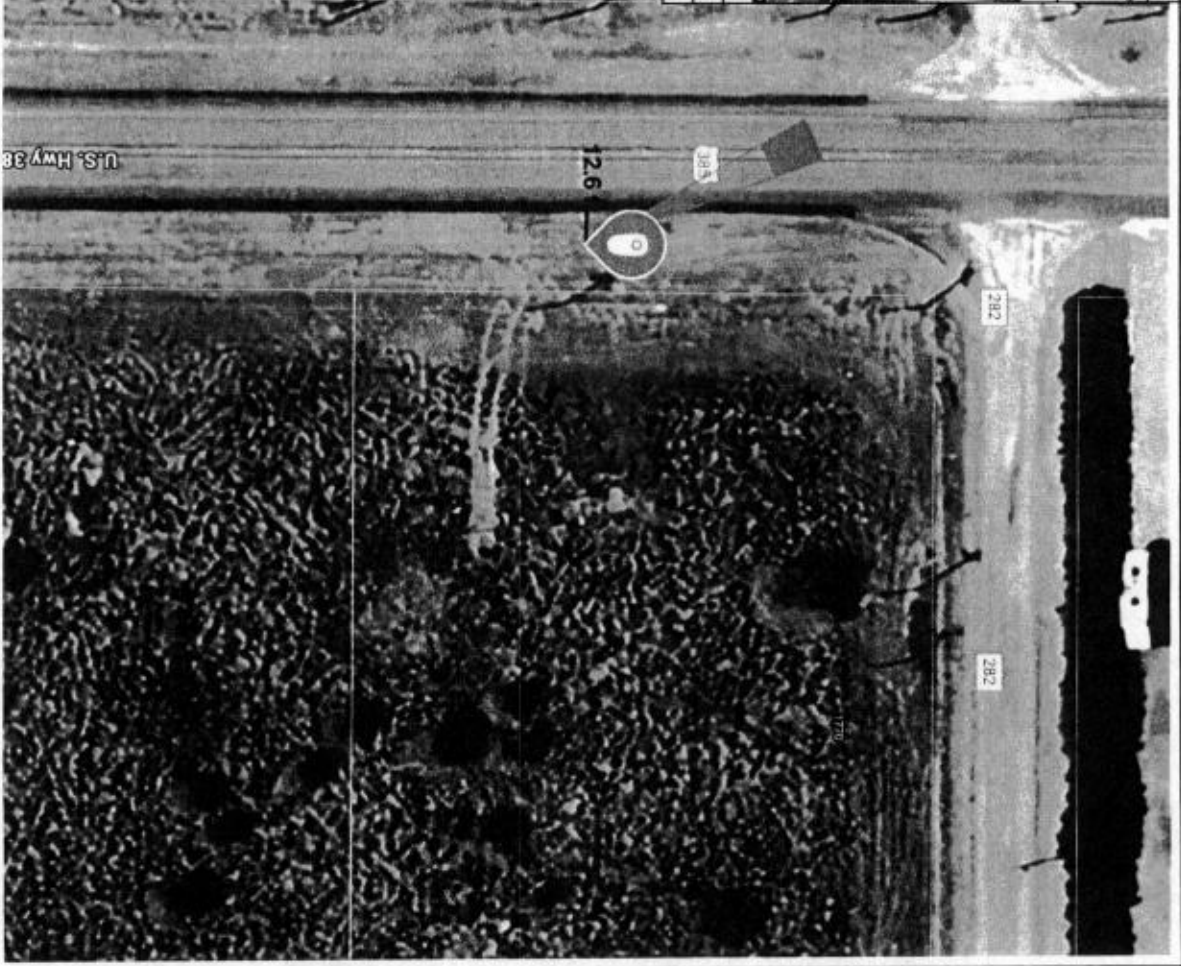

TX - Lubbock County SO

00876058

Flock Safety  
 1170 HOWELL WILL ROAD SUITE 210  
 ATLANTA, GA 30318

REV	DATE	BY	DESCRIPTION
-	-	-	-
-	-	-	-
-	-	-	-
0	12/30/2024	FLK	PRELIM

I HEREBY CERTIFY THIS DOCUMENT WAS PREPARED BY AN INDIVIDUAL WHO IS A LICENSED PROFESSIONAL ENGINEER IN THE STATE OF TEXAS AND WHO HAS DIRECT KNOWLEDGE OF THE STATE OF TEXAS.

FLOCK SAFETY EQUIPMENT INSTALLATION

CASE NUMBER: 00876058  
 PERMITTING JURISDICTION: Texas (DOT) Lubbock (S), Right-of-Way

COVER SHEET & LOCATION MAPS

SHEET  
 A.03

REV  
 0



FLOCK LOCATION DETAILS

LOCATION NAME: PARADISE @ McCarty St EB - Lewis County  
 GEOGRAPHIC COORDINATES:  
 34.07089738608798, -102.52837348576356

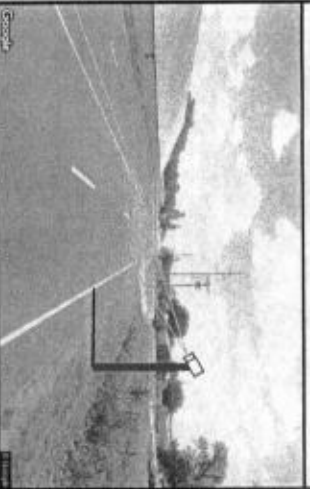

STREET NAME/RSR #	SPEED LIMIT	TRAFFIC VOLUME	ICOP DISTANCE
508 Railroad Ave	90	7201	10.2 ft
Corresponding Spec Sheet: SPEC 01-03			



TX - Lubbock County SO  
 00876056

Flock Safety  
 1170 HOWELL MILL ROAD SUITE 210  
 ATLANTA, GA 30319

REV	DATE	BY	DESCRIPTION
0	12/30/2024	FLX	PRELIM

THIS DOCUMENT HAS BEEN PREPARED BY AN ENGINEER OR ARCHITECT FOR THE PURPOSE OF PROVIDING PROFESSIONAL SERVICES TO THE CLIENT. IT IS NOT TO BE USED FOR ANY OTHER PURPOSE WITHOUT THE WRITTEN CONSENT OF THE ENGINEER OR ARCHITECT.

FLOCK SAFETY EQUIPMENT INSTALLATION  
 CASE NUMBER: 00876056  
 PERMITTING JURISDICTION: Texas (DOT) Lubbock  
 (S), Right-of-Way

COVER SHEET & LOCATION MAPS	
SHEET A.04	REV 0

# FLOCK LOCATION DETAILS

LOCATION NAME: F10041 Hall Ave @ E 28th St SB - Lamb County  
 GEOGRAPHIC COORDINATES:  
 33.886508972387725, -102.32746771131045

STREET NAME/DIR	SPEED LIMIT	TRAFFIC VOLUME	EOP DISTANCE
28th Hall Ave	55	2300	18.3 ft
Corresponding Spec Street		SPEC.01.03	



TX - Lubbock County SO  
 00876056

Flock Safety  
 11770 HOWELL WALL ROAD SUITE 210  
 ATLANTA, GA 30338

REV	DATE	BY	DESCRIPTION
0	12/30/2024	FLK	PRELIM

1. OWNER REVIEW THIS DOCUMENT AND PREPARED BY INSIST OF  
 UNDER BY DIRECT SUPERVISION AND THAT I AM DAILY REQUIRE  
 ENGINEER UNDER THE LAWS OF THE STATE OF TEXAS

FLOCK SAFETY EQUIPMENT INSTALLATION  
 CASE NUMBER: 00278093  
 PERMITTING JURISDICTION: Texas (0001) Lubbock  
 (S), Right-of-Way

COVER SHEET & LOCATION MAPS	REV
SHEET A.05	0

# DESIGN NOTES

1. POLE AND FOUNDATIONS ARE DESIGNED IN ACCORDANCE WITH THE FOLLOWING CODES:

- 1.1 2015 MICHIGAN BUILDING CODE
- 1.2 2015 MICHIGAN ELECTRICAL CODE
- 1.3 2015 MICHIGAN MECHANICAL CODE
- 1.4 2015 MICHIGAN PLUMBING CODE
- 1.5 2015 MICHIGAN FIRE CODE
- 1.6 2015 MICHIGAN GAS CODE
- 1.7 2015 MICHIGAN HAZARDOUS LIQUID CODE
- 1.8 2015 MICHIGAN SOLID WASTE CODE
- 1.9 2015 MICHIGAN WASTE WATER CODE
- 1.10 2015 MICHIGAN WASTE AIR CODE
- 1.11 2015 MICHIGAN WASTE WATER TREATMENT CODE
- 1.12 2015 MICHIGAN WASTE WATER REUSE CODE
- 1.13 2015 MICHIGAN WASTE WATER REUSE TREATMENT CODE
- 1.14 2015 MICHIGAN WASTE WATER REUSE TREATMENT TREATMENT CODE
- 1.15 2015 MICHIGAN WASTE WATER REUSE TREATMENT TREATMENT TREATMENT CODE
- 1.16 2015 MICHIGAN WASTE WATER REUSE TREATMENT TREATMENT TREATMENT TREATMENT CODE
- 1.17 2015 MICHIGAN WASTE WATER REUSE TREATMENT TREATMENT TREATMENT TREATMENT TREATMENT CODE
- 1.18 2015 MICHIGAN WASTE WATER REUSE TREATMENT TREATMENT TREATMENT TREATMENT TREATMENT TREATMENT CODE
- 1.19 2015 MICHIGAN WASTE WATER REUSE TREATMENT TREATMENT TREATMENT TREATMENT TREATMENT TREATMENT TREATMENT CODE
- 1.20 2015 MICHIGAN WASTE WATER REUSE TREATMENT TREATMENT TREATMENT TREATMENT TREATMENT TREATMENT TREATMENT TREATMENT CODE

2. POLE ANALYSIS AND FOUNDATION DESIGN ARE BASED ON THE FOLLOWING CRITERIA:

- 2.1 DESIGN WIND SPEED (MILITARY): 115 MPH (MAXIMUM)
- 2.2 RISK CATEGORY: C
- 2.3 EXPOSURE CATEGORY: I
- 2.4 TOPOGRAPHIC CATEGORY: D
- 2.5 SEISMIC DESIGN CATEGORY: B
- 2.6 SEISMIC DESIGN CATEGORY: B
- 2.7 SEISMIC DESIGN CATEGORY: B
- 2.8 SEISMIC DESIGN CATEGORY: B
- 2.9 SEISMIC DESIGN CATEGORY: B
- 2.10 SEISMIC DESIGN CATEGORY: B
- 2.11 SEISMIC DESIGN CATEGORY: B
- 2.12 SEISMIC DESIGN CATEGORY: B
- 2.13 SEISMIC DESIGN CATEGORY: B
- 2.14 SEISMIC DESIGN CATEGORY: B
- 2.15 SEISMIC DESIGN CATEGORY: B
- 2.16 SEISMIC DESIGN CATEGORY: B
- 2.17 SEISMIC DESIGN CATEGORY: B
- 2.18 SEISMIC DESIGN CATEGORY: B
- 2.19 SEISMIC DESIGN CATEGORY: B
- 2.20 SEISMIC DESIGN CATEGORY: B

3. STRUCTURE BASE REACTIONS ARE CALCULATED AS FOLLOWS:

- 3.1 ULTIMATE BASE MOMENT: 2,700 LB-FT
- 3.2 ULTIMATE BASE SHEAR: 300 LB
- 3.3 ULTIMATE BASE AXIAL: 100 LB

4. SHOULD ANY OF THE SITE SPECIFIC PARAMETERS BE HIGHER THAN WHAT IS NOTED ABOVE, THE EOR SHALL BE CONTACTED TO PROVIDE A REVISED DESIGN.

5. POLE STRUCTURE SHALL BE INSTALLED ON A FOUNDATION WITH FLAT BEARING SURFACE. THE TOP OF THE TOP OF THE FOUNDATION OUTSIDE OF THE BASE PLATE FOOTPRINT SHALL BE SLOPED BETWEEN 1" AND 3" TO ALLOW FOR ADEQUATE DRAINAGE.

## GENERAL & CONSTRUCTION NOTES

1. CONTRACTOR SHALL BE RESPONSIBLE TO CONTACT B11 TO LOCATE ALL UNDERGROUND UTILITIES 48 HOURS PRIOR TO CONSTRUCTION START DATE.
2. CONTRACTOR SHALL BE RESPONSIBLE FOR APPLYING AND OBTAINING APPROVED TRAFFIC CONTROL PLANS IN ACCORDANCE WITH MUTCD AND LOCAL JURISDICTION STANDARDS AS REQUIRED.
3. CONTRACTOR SHALL BE RESPONSIBLE FOR THE RESTORATION OF ANY DISTURBED AREAS TO ORIGINAL CONDITION TO STATE DEPARTMENT OF TRANSPORTATION AND LOCAL JURISDICTION AT NO ADDITIONAL COMPENSATION.
4. ALL WORK SHALL ABIDE BY ALL APPLICABLE NATIONAL ELECTRICAL CODES EXCEPT WHEN THE STATE DEPARTMENT OF TRANSPORTATION AND LOCAL JURISDICTION STANDARDS SUPERSEDE.
5. POLE SHOULD BE GROUND TO A SOLID BARE BOND GROUNDING & GROUNDING ROD (OR COIL 25' OR #4 BARE COPPER) IN POLE FOUNDATION AND BACK TO PROPOSED FLOCK EQUIPMENT.
6. ALL CONSTRUCTION SHALL BE IN ACCORDANCE WITH STATE DEPARTMENT OF TRANSPORTATION AND LOCAL JURISDICTION SPECIFICATIONS UNLESS SPECIFICALLY STATED OR SHOWN OTHERWISE HEREIN.
7. CONTRACTOR SHALL BE RESPONSIBLE TO DETERMINE THE SOIL TYPE AND SUITABILITY REQUIREMENTS PRIOR TO CONSTRUCTION PER PROJECT MANAGER DIRECTIVE.

## ADA COMPLIANCE NOTES

1. ALL SIDEWALK CONSTRUCTION SHALL BE IN ACCORDANCE WITH ADA TITLE II AND ALL STATE DEPARTMENT OF TRANSPORTATION AND JURISDICTION STANDARDS.
2. USE STATE SPECIFIC DEPARTMENT OF TRANSPORTATION CURRENT EDITION STANDARDS FOR PEDESTRIAN CONTROL PLANS FOR SIDEWALK AND WALKWAY CLOSURES.
3. MINIMUM SIDEWALK CLEARANCE FOR PEDESTRIAN ACCESS ROUTE (PAR) IS 48" WIDE.
4. MINIMUM CLEARANCE OF ANY PROPOSED EQUIPMENT ALONG THE WIDTH OF THE SIDEWALK IS 7'-0" IN HEIGHT.

## 1 POLE ELEVATION DETAIL

SCALE: N/A

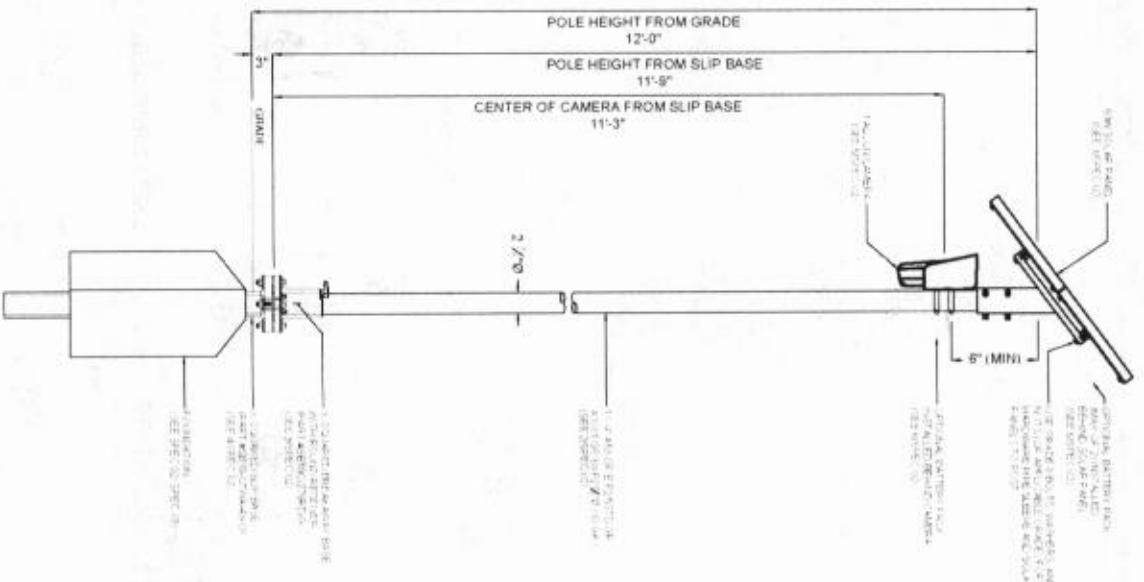

TX - Lubbock County SO  
008/70058

Flood Safety  
1170 HOWELL MILL ROAD SUITE 210  
ATLANTA, GA 30318

REV	DATE	BY	DESCRIPTION
-	-	-	-
-	-	-	-
-	-	-	-
0	12/30/2024	FLK	PRELIM

DESIGNED BY: THIS DOCUMENT WAS PREPARED BY A PROFESSIONAL ENGINEER UNDER THE SUPERVISION OF A LICENSED PROFESSIONAL ENGINEER UNDER THE LAWS OF THE STATE OF TEXAS.

FLOCK SAFETY EQUIPMENT INSTALLATION  
CASE NUMBER: 008/70058  
PERMITTING JURISDICTION: Texas (DOT) Lubbock (S), Right-of-Way

COVER SHEET & LOCATION MAPS	REV
SHEET SPEC:01	0

# 60 WATT SOLAR PANEL AND MOUNT ASSEMBLY (TOP MOUNTED)

MODEL 12100111 SUPPLIED BY FLOCK SAFETY
WEIGHT 25 LB. APPROX.
MOUNTING HARDWARE TO BE PROVIDED BY FLOCK SAFETY

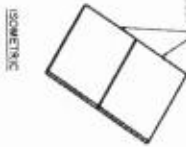
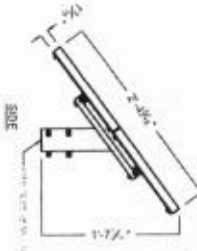
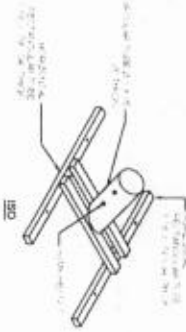
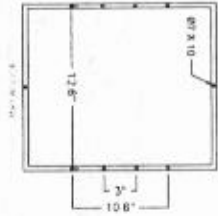
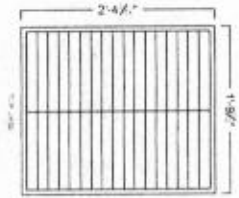

## RED-TORQUE POST BASE SB10C-278RD-G

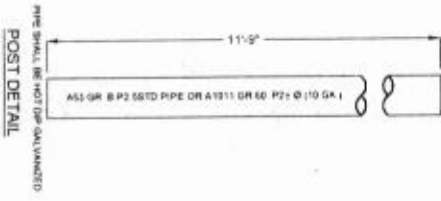
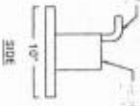

# OPTIONAL "PENGUIN" BATTERY PACK (MAX 3)

MODEL 1210002
WEIGHT 4 LB. EACH APPROX.
MOUNTING HARDWARE TO BE PROVIDED BY FLOCK SAFETY

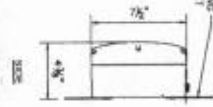

## AUTOMATIC LICENSE PLATE READER CAMERA DETAIL

MODEL 1210009
WEIGHT 5 LB. APPROX.
MOUNTING HARDWARE TO BE PROVIDED BY FLOCK SAFETY

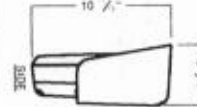

## FOUNDATION DETAIL - SURFACE MOUNT OPTION

SURFACE MOUNTING
MOUNTING HARDWARE TO BE PROVIDED BY FLOCK SAFETY

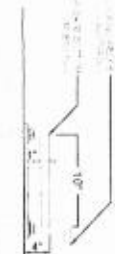

TX - Lubbock County SO 008/76258			
Flock Safety 1170 HOWELL MILL ROAD SUITE 210 ATLANTA, GA 30318			
REV	DATE	BY	DESCRIPTION
-	-	-	-
-	-	-	-
-	-	-	-
0	12/30/2024	FLK	PRELIM
I HEREBY CERTIFY THIS DOCUMENT WAS PREPARED BY MYSELF OR UNDER MY DIRECT SUPERVISION AND I AM A LICENSED PROFESSIONAL ENGINEER UNDER THE LAWS OF THE STATE OF TEXAS.			
FLOCK SAFETY EQUIPMENT INSTALLATION CASE NUMBER: 008/76258 PERMITTING JURISDICTION: Texas (DOT) Lubbock (D), Right-of-Way			
COVER SHEET & LOCATION MAPS SHEET: REV SPEC.02 0			





